

SS/TRAV

MENU

TEXT

100 ft

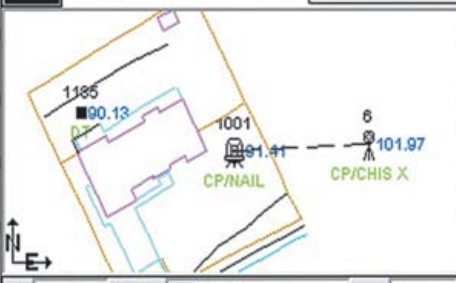

Pt: 1001 Desc: DT HT: 6.56
 AR: ZA: SD:

R
S
T
O
C
↑

Carlson Explorer 600+

1ST CTRL CHG LOW BAT 2ND ALT CAPS

Esc Ctrl Shift Tab

Fn PgUp 2nd

Del Home PgDn Alt

Bk Sp

7 8 9 0
 & _ ?

4 5 6 .
 \$ % ^ ,

1 2 3 A
 | @ # \ / Avg/All

B C D E F
 + - * =
 Inst Contig Sky/Dist Elev Frz Pts

G H I J K
 " ' : ; |
 Go-Stop Help Inv Robot Calc

L M N O P
 \ < > ()
 Codes Map Next Offset Points

Q R S T U
 () | |
 Hgt-Desc Read Store Trav Ins

V W X Y Z
 Caps Start TG BkLt+ BkLt-
 View Notes Exit Txt-Graph Zoom Pt

Carlson Explorer 600+

624 Mhz High-Speed Data Collector. The fastest most powerful, ruggedized mobile hand held computer available today.

Powered with
Carlson SurvCE

High Speed Processor

Fast 624 Mhz Xscale processor!

More Memory

- 128Mb SDRAM
- 512Mb System Flash

Powerful Software

Starting at only \$2995 with Carlson SurvCE installed!

More Durable

Weather resistant shell rated to withstand wind-driven rain

Better Control

New keyboard designed for surveyors! Handstrap and stylus.

Bright Display

QVGA-TFT color, sunlight readable touch screen

Powerful Connectivity

- Comes standard with WiFi and Bluetooth
- USB port, Serial port, CF slot

Convenient handstrap and stylus



Compact flash card slot, RS232 serial and USB interface



Carlson Explorer 600+ Specifications:

Power:

- Nickel Metal Hydride rechargeable batteries (1500 mAh, 7.2V)
- AA Alkaline batteries (6)
- Recharge/Line Power: 11 to 18 VDC, 1.5A
- 8 hours minimum operating time

Display:

- QVGA-TFT color sunlight readable display, with white LED Backlight
- Resolution: 320 x 240 pixels color
- Touch Screen

Environmental:

- Operating temperature: -20°C to +50°C
- Storage temperature: -20°C to +70°C
- Charging Temperature: -20°C to +40°C
- Humidity: 5 - 95% Non-condensing
- IP65 ingress protection

CPU:

- Type: Intel PXA270 processor with Xscale technology
- Speed: 624 MHz
- Operating System: Windows CE .NET 4.2 or 5.0 professional

Memory and Mass Storage:

- SDRAM: 128MB
- Internal Compact Flash: 512MB
- Compact flash card slot

Interface:

- Internal Wireless LAN 802.11b
- Internal Bluetooth®
- USB Port
- RS-232 Serial Port

User Input:

- Touch screen
- Full function alpha numeric elastomeric keyboard

Indicators:

- 5 programmable LED Indicators including Charge/Low Battery Indicator

Physical Dimensions:

- Height (H): 9.84 inches (250mm)
- Width (W): 4.75 inches (120.7mm)
- Depth (D): 1.83 inches (46.5mm)
- Weight with NiMH Batteries: 29 ounces (822 grams)

Warranty:

- Two years

For sales information or to locate a dealer please call: **800-989-5028**



Carlson
www.carlsonsw.com



SS/TRAV

MENU

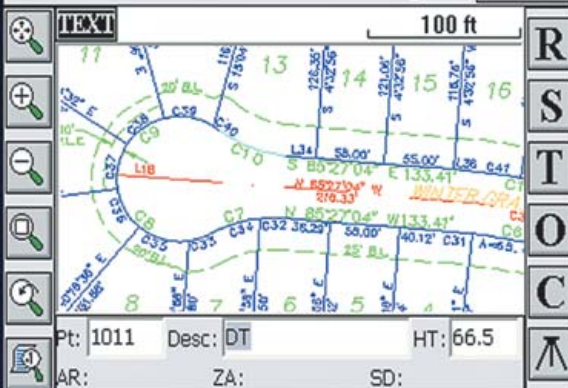

Carlson Explorer 600+

1ST 2ND

CTRL ALT

CHG LOW CAPS

Esc Ctrl Shift Tab

Fn PgUp 2nd

Del Home End Alt

Bk PgDn Sp

7 8 9 0

4 5 6 .

1 2 3 A

B C D E F

Inet Config Sky/Dist Elev Frz Pts

G H I J K

Go-Stop Help Inv Robot Calc

L M N O P

Codes Map Next Offset Points

Q R S T U

Hgt-Desc Read Store Trav

V W X Y Z

View Notes Exit Txt-Graph Zoom Pt